



Flotilla House

Juniper Drive, Battersea Reach, SW18 1FX

£462 Per Week

A well presented two double bedroom 5th floor apartment (lifts) is situated within one of London's most prestigious riverside developments, The Flotilla House being located peacefully at the 'Battersea Reach' development and benefits from all of the amenities which include; Gym on site, riverside restaurants & coffee shops, 24 hour concierge service; with underground parking available to rent.

The property comprises of:- Entrance Hallway, bright lounge with semi-open plan fully fitted kitchen, private balcony with view of the river Thames, two double bedrooms (master with en-suite shower/WC), large family bathroom/WC. The property is now offered furnished and available now for long let.

An ideal property for couple with child and/or professionals sharing.

- Two Double Bedrooms
- Fifth Floor
- Balcony
- 24 Hour Concierge
- Wooden Flooring

Viewing

Please contact our Messila Residential Office on 020 7586 6699 if you wish to arrange a viewing appointment for this property or require further information.



Floor Plan

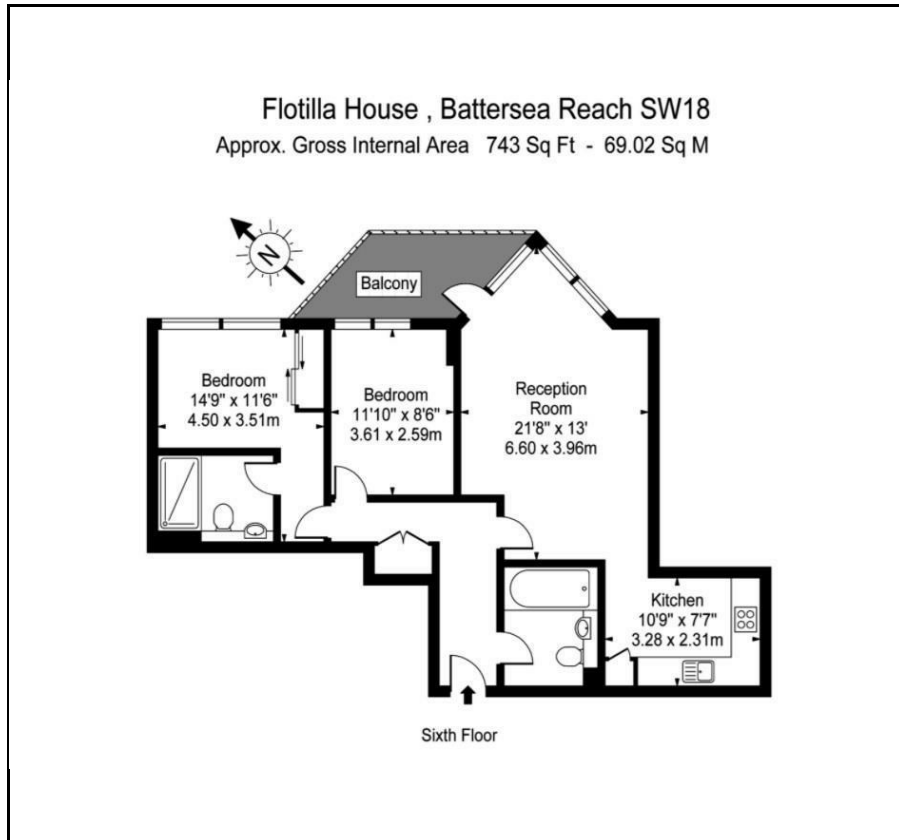

Area Map



Energy Efficiency Graph

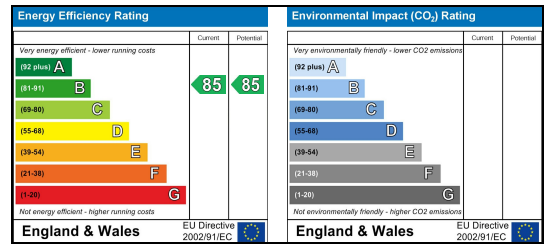

These particulars, whilst believed to be accurate are set out as a general outline only for guidance and do not constitute any part of an offer or contract. Intending purchasers should not rely on them as statements of representation of fact, but must satisfy themselves by inspection or otherwise as to their accuracy. No person in this firm's employment has the authority to make or give any representation or warranty in respect of the property.

Messila Residential

137 Park Road, London, NW8 7HT

T: 020 7586 6699 E: regentspark@messilaresidential.com W: messilaresidential.com