



- Fabulous Three Bedroom Detached Bungalow
- Open Plan Kitchen Dining Living Room
- Beautiful Bathroom Suite, Two En-Suites

14 Pleasant Grove, Thornton-Cleveleys, FY5 4AG

£234,950

MAGNIFICENT TWO/THREE BEDROOM DETACHED TRUE BUNGALOW - PRESENTED TO AN EXCEPTIONAL STANDARD WITH NO EXPENSE SPARED AND EVERY DETAIL CAREFULLY CONSIDERED THIS WONDERFUL PROPERTY OFFERS A COMPLETELY UNIQUE WAY OF LIFE - VIEWING IS ESSENTIAL TO APPRECIATE THE STANDARD THROUGHOUT - NO CHAIN DELAY.



Property Description

HALLWAY

Double glazed window and door to front, laminate flooring, door leading into boiler cupboard, bespoke panelling to all walls and complimentary decorative radiator. Opening into kitchen dining living room.

KITCHEN/DINER/LIVING ROOM

21' 1" x 13' 10" (6.44m x 4.22m) Fitted with a modern matching range of base and eye level units with worktop space over and drawers, sink unit with single drainer and mixer tap, built-in dishwasher, plumbing for washing machine, built-in electric oven, built-in four ring ceramic hob, two double glazed windows to front, two decorative radiators, laminate flooring, feature timber television station with stunning inset fireplace, tiered ceiling with remote controlled colour changing LED lighting, door to rear garden.

BEDROOM.1

15' 10" x 12' 5" (4.83m x 3.79m) Double glazed window to front, decorative radiator, fitted carpet, Scandinavian style illuminated timber headboard with low-level industrial style pendant lighting, sliding door to:

ENSUITE

Fitted with a contemporary three-piece suite comprising; bespoke feature wash hand basin, tiled shower enclosure and low-level WC, tiled surround, heated towel rail, motion sensor lighting.

BEDROOM 2

11' 10" x 8' 9" (3.61m x 2.69m) Double glazed window to rear, decorative radiator, fitted carpet, Scandinavian style illuminated timber headboard with low-level industrial style pendant lighting, TV point, sliding door to:

ENSUITE

Fitted with a contemporary three-piece suite comprising;





bospoke feature wash hand basin, tiled shower enclosure and low-level WC, tiled surround, heated towel rail, motion sensor lighting.

BEDROOM 3/SECOND RECEPTION

12' 5" x 11' 10" (3.8m x 3.63m) Double glazed windows to rear and side, decorative radiator, fitted carpet, wall mounted TV station.

BATHROOM

Fitted with a fabulous four-piece suite comprising L-shaped panelled bath, floating wash hand basin, tiled double shower enclosure and low-level WC, all with matt black bathroom fittings that coincide with the black door furnishings throughout the property, tiled surround, double glazed window to rear, heated towel rail, tiled flooring.

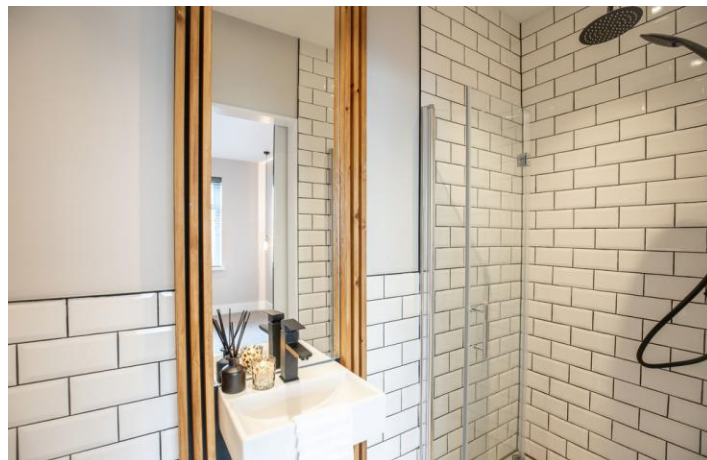

GARAGE

Double in length the garage has a manual door providing access and door accessing from the rear garden. Power and light installed it offers fantastic potential to covert into a home office or gym. Water is also provided as well as plumbing for the washing machine.

GARDENS

To the front of the property is a driveway providing off road parking. Wrapped around all elevations are lawned gardens with shrubbed borders. The rear garden faces south and has power provided to accomodate a hot-tub.



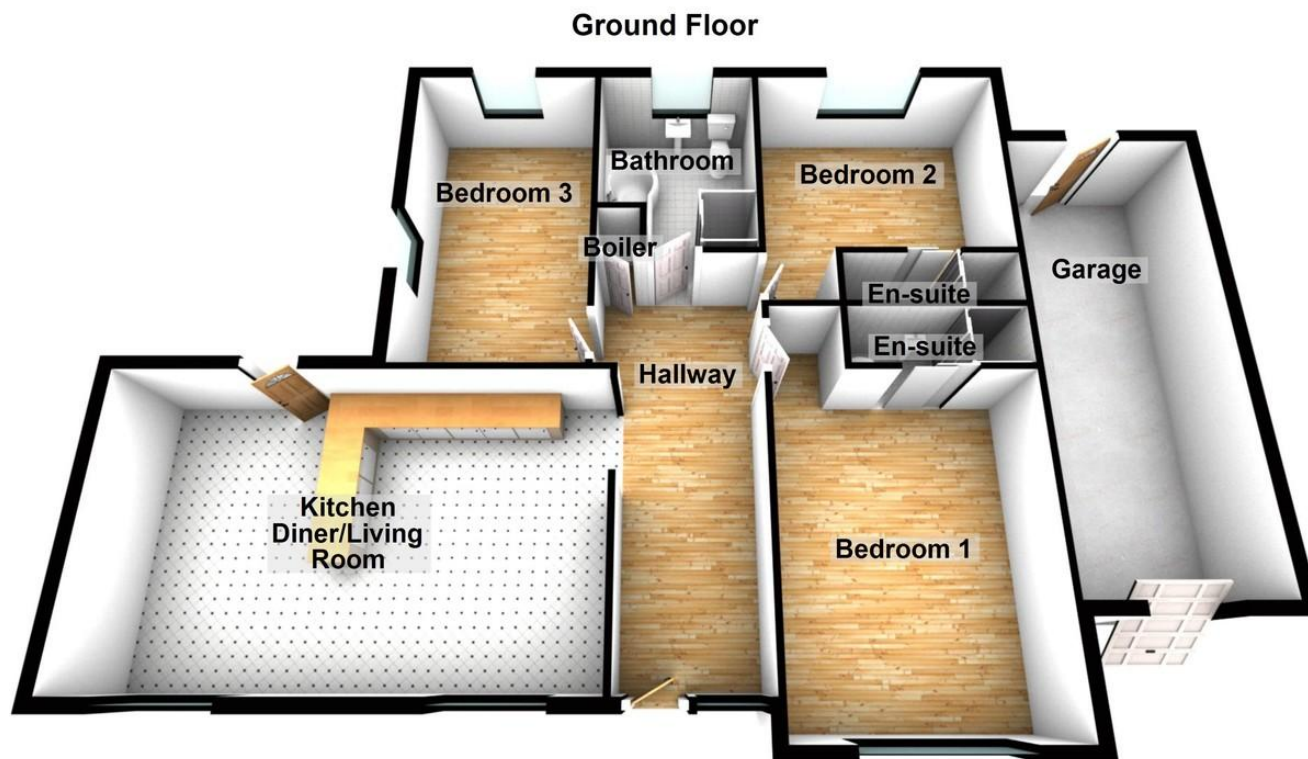

%epcGraph_c_1_334%

29 Whitegate Drive, Blackpool,
Lancashire, FY3 9AA

www.romanjamesestates.co.uk
01253 978888
info@romanjamesestates.co.uk

Agents Note: Whilst every care has been taken to prepare these sales particulars, they are for guidance purposes only. All measurements are approximate are for general guidance purposes only and whilst every care has been taken to ensure their accuracy, they should not be relied upon and potential buyers are advised to recheck the measurements