

GROUND FLOOR
608 sq.ft. (56.5 sq.m.) approx.

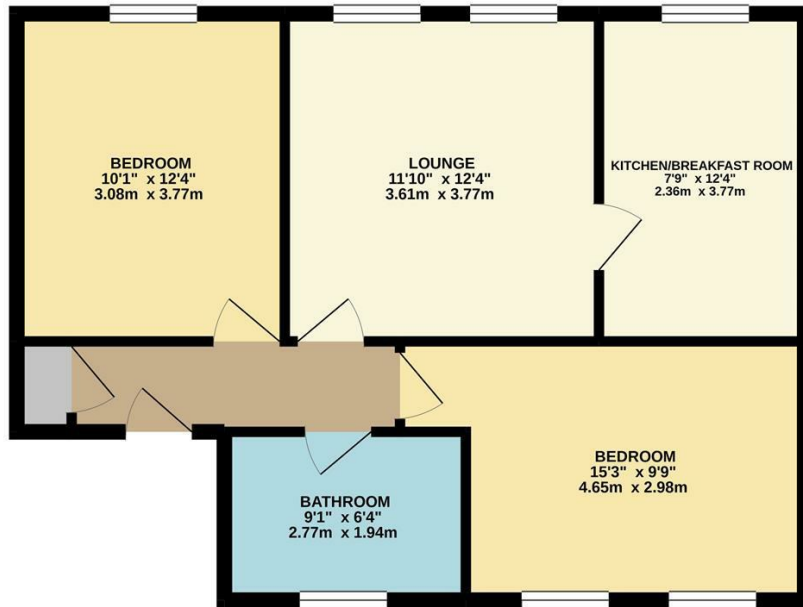

TOTAL FLOOR AREA : 608 sq.ft. (56.5 sq.m.) approx.
Whilst every attempt has been made to ensure the accuracy of the floorplan contained here, measurements of doors, windows, corners and any other items are approximate and no responsibility is taken for any error, omission or mis-statement. This plan is for illustrative purposes only and should be used as such by any prospective purchaser. The services, systems and appliances shown have not been tested and no guarantee as to their operability or efficiency can be given.
Made with Metropix ©2021



Charles Rose is proud to present this immaculately presented first floor two bed apartment located in the heart of Warwick town centre. Further benefiting from secure gated parking (a 2 minute walk from the property) perfectly situated to enjoy the town's pubs, restaurants and shops.

Internally the property comprises of an entrance hall, two double bedrooms, a breakfast kitchen, a family bathroom and a fitted intercom. The apartment also has secure gated access from two sides.

charlesrose.

- 01926 832411
- info@charlesroseproperties.co.uk
- www.charlesroseproperties.co.uk

