



212 Mariners Court Lamberts Road

Marina, Swansea, SA1 8QW

£49,000



FULL DESCRIPTION

ENTRANCE

Second floor apartment. Lift access.
Entrance via hardwood door to:-

HALLWAY

Wall mounted gas central heating radiator. Wall mounted intercom. Door to storage cupboard housing hot water tank, shelving and light. Doors to Bathroom, Master bedroom, Bedroom two and open-plan lounge/kitchen.

BATHROOM

7'5" x 6'8" (2.26 x 2.03)

Fitted with a three piece white suite comprising low level w.c, pedestal wash hand basin and panelled bath with mixer shower over and glass shower screen. Part tiled walls. Wall mounted gas central heating radiator.

MASTER BEDROOM

15'2" x 10'2" (4.62 x 3.10)

Double glazed window. Mirrored fitted wardrobes. Wall mounted gas central heating radiator.

BEDROOM TWO

10'4" x 5'9" to wardrobes (3.15 x 1.75 to wardrobes)

Double glazed window. Mirrored fitted wardrobes. Wall mounted gas central heating radiator.

LOUNGE/DINER OPEN-PLAN TO KITCHEN

22'1" x 11'7" max (6.73 x 3.53 max)

LOUNGE/DINER

Double glazed french doors leading to decked sit-out sun balcony with glass balustrade. Two wall mounted gas central heating radiators.

KITCHEN

Fitted with a range of wood effect wall, base and drawer units with black worktop and tiled splash back. Inset stainless steel sink unit. Stainless steel single eye level oven. Inset halogen electric hob with stainless steel chimney hood extractor fan.

EXTERNAL

Underground secure parking space.

Service charge includes gas heating and hot water, water rates, building insurance, cleaning and maintenance of communal areas.

AREA MAP



FLOOR PLANS

GROUND FLOOR

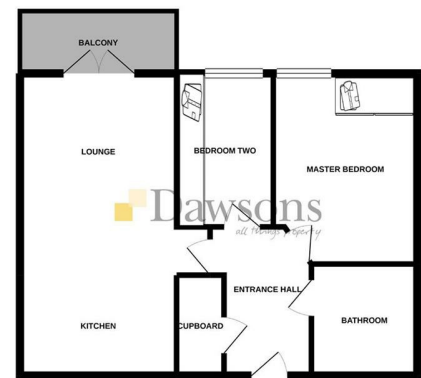

EPC

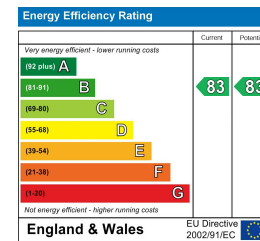

These particulars, whilst believed to be accurate are set out as a general outline only for guidance and do not constitute any part of an offer or contract. Intending purchasers should not rely on them as statements or representations of fact, but must satisfy themselves by inspection or otherwise as to their accuracy. No person in this firm's employment has the authority to make or give any representation or warranty in respect of the property.



Unit A, Meridian Bay, Swansea, SA1 1PG

T 01792 653100 E sa1sales@dawsonsproperty.co.uk

W dawsonsproperty.co.uk

