



David Astburys



Wolseley Road, Crouch End N8
£350,000
Leasehold

15 Park Road, Crouch End, London, N8 8TE
davidastburys.com
0203 000 6787 | sales@davidastburys.com

15 Park Road, Crouch End, London, N8 8TE
davidastburys.com
0203 000 6787 | sales@davidastburys.com

- 532 Square Feet
- Ground Floor
- Scope for Refurbishment
- Open Plan Kitchen/Reception
- Period Building
- Close To Crouch End Broadway
- Highgate Station (0.7 miles)
- Chain Free



Wolseley Road, N8

Approximate Gross Internal Area = 532 sq ft / 49.4 sq m

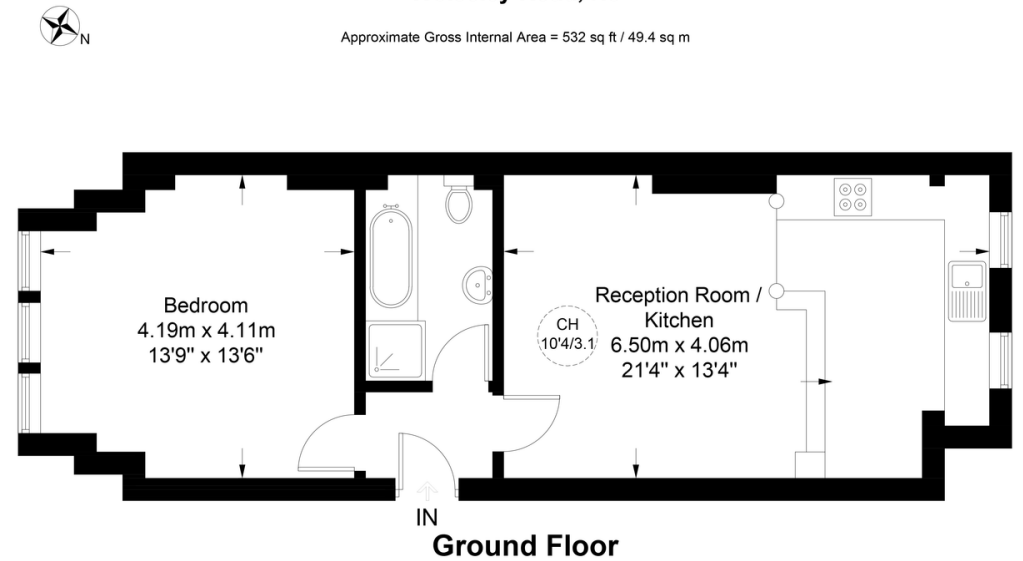

This plan is for layout guidance only. Not drawn to scale unless stated. Windows and door openings are approximate. Whilst every care is taken in the preparation of this plan, please check all dimensions, shapes and compass bearings before making any decisions reliant upon them. (ID730003)