

*Jordan Fishwick*

GREEN QUARTER  
Vallea Court



## Vallea Court, Green Quarter M4 4FE

Offers in excess of £150,000



### The Property

CASH BUYERS ONLY! Video Online .. <https://youtu.be/bXQMLClvq0E>

This spacious FOURTEENTH floor one bedroom apartment is set in Vallea Court which is located within the Green Quarter development, only a short walk from Market Street, Arndale Centre and Victoria Train and Metrolink Stations. The apartment is owner occupied and has been kept in immaculate condition.. The property has an open plan kitchen/living area with the kitchen is of a high quality and has a fully integrated fridge freezer, dishwasher, microwave and oven. The bedroom is a generous size double and there is also a contemporary three-piece family bathroom off the hallway.

This apartment would achieve £750 PCM giving it a gross yield of 6%

### Directions

Vallea Court is located in the Green Quarter which is a short stroll from Victoria Train Station, The Printworks and MEN Arena.

- Cash Buyers Only
- Fourteenth Floor Apartment
- One Bedroom
- Immaculate Condition
- High Specification Kitchen and Bathroom
- Balcony
- Rental Potential £750 PCM
- Gross Yield 6%

**Postcode** - M4 4FE

**EPC Rating** -

**Floor Area** - sq ft

**Local Authority** - Manchester City Council

**Council Tax** - Band C



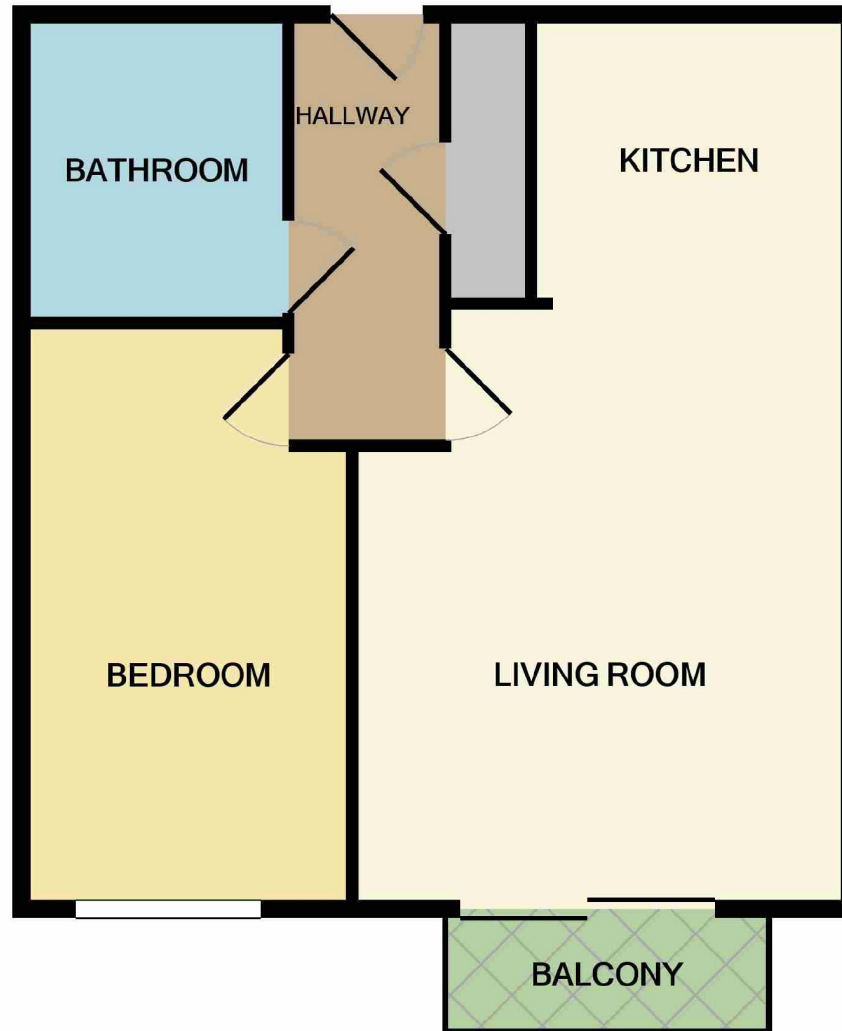

Measurements are approximate. Not to scale. Illustrative purposes only  
Made with Metropix ©2020



These particulars are believed to be accurate but they are not guaranteed and do not form a contract. Neither Jordan Fishwick nor the vendor or lessor accept any responsibility in respect of these particulars, which are not intended to be statements or representations of fact and any intending purchaser or lessee must satisfy himself by inspection or otherwise as to the correctness of each of the statements contained in these particulars. Any floorplans on this brochure are for illustrative purposes only and are not necessarily to scale.

Offices also at:  
Chorlton | Didsbury | Disley | Glossop | Hale | Macclesfield | Manchester | Sale | Wilmslow | Withington

68 The Arches, Whitworth Street West, Manchester, M1

**0161 833 9499**

[manchester@jordanfishwick.co.uk](mailto:manchester@jordanfishwick.co.uk)

[www.jordanfishwick.co.uk](http://www.jordanfishwick.co.uk)