



Grosvenor House, Cheltenham, GL52 2AA

**£1,000 PCM**









# Grosvenor House

Cheltenham, GL52 2AA

- Lower Ground Floor
- Two Double Bedrooms
- Regency Style - Ultra-Modern Living
- Parking

Available Now - Lower Ground Floor : Superior 2 double bedroom unfurnished flat in Pittville, close to the town centre.

£1,000 PCM







Directions







Floor Plans

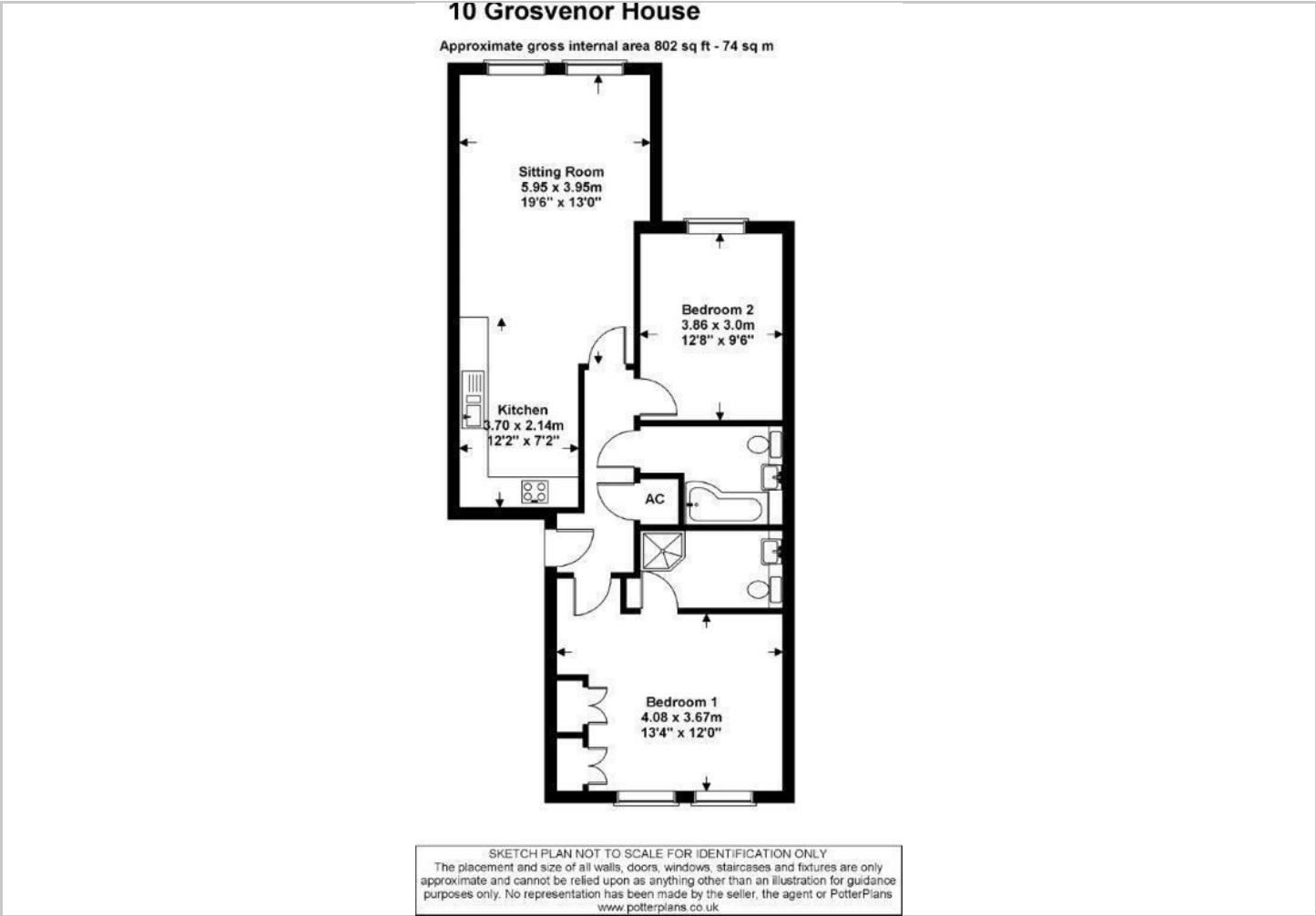

Viewing

Please contact our HMT Office on 01242 521322 if you wish to arrange a viewing appointment for this property or require further information.

The particulars are set out as a general outline only for the guidance of intended purchasers or lessees, and do not constitute, any part of a contract. Nothing in these particulars shall be deemed to be a statement that the property is in good structural condition or otherwise nor that any of the services, appliances, equipment or facilities are in good working order. Purchasers should satisfy themselves of this prior to purchasing.

2 Crescent Terrace, Cheltenham, Gloucestershire, GL50 3PE  
Tel: 01242 521322 Email: info@hmt.co.uk www.hmt.co.uk

Location Map



Energy Performance Graph

