

# Flat 12 77-79 Upper Chorlton Road, Whalley Range, M16 7BR



*JP&Brimelow*  
SALES



# Price: £150,000

**\*\*VIDEO TOUR AVAILABLE\*\*** A beautifully presented & fully refurbished ONE DOUBLE BEDROOMED, raised ground floor duplex apartment within this attractive development here in Whalley Range. Situated in a highly popular residential area on the borders of Whalley Range and Old Trafford. Within walking distance of the Tesco Extra and the independent shops available on Ayres Road in Old Trafford. With a bus stop outside the development giving direct access into the City Centre/Media City/ Chorlton and the Metrolink station on Seymour Grove. Apartment 12 is a well portioned apartment comprising; on the raised ground floor there is a communal entrance hallway, a private entrance hallway, a stunning fully fitted kitchen/dining/lounge area, and a W/C. To the lower ground floor level there is a landing leading to the double bedroom and a white three-piece family bathroom. The property benefits from electric heating, double glazing throughout, an alarm control panel, entry via intercom, a parking space to the rear with attractive communal lawned gardens. Will suit either a first-time buyer or a professional couple due to location. OFFERED WITH NO CHAIN. Early viewing is highly recommended.





EPC Chart

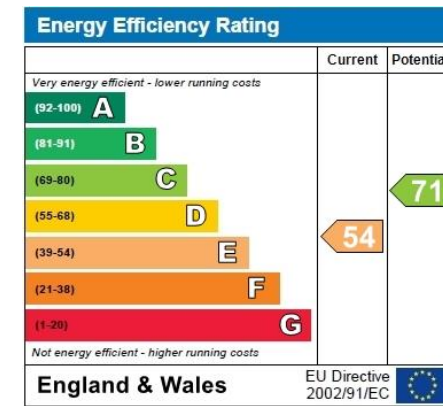

Leasehold With a NEW lease of 250 years. The monthly service charge is £65pcm. Annual ground rent is £150pa. (Information as per current vendor) February 2021.  
Council Tax Band: B

Lower Ground Floor

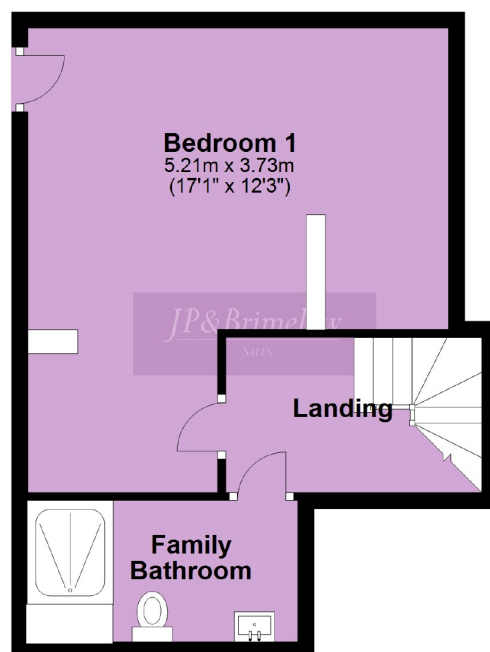

Upper Ground Floor

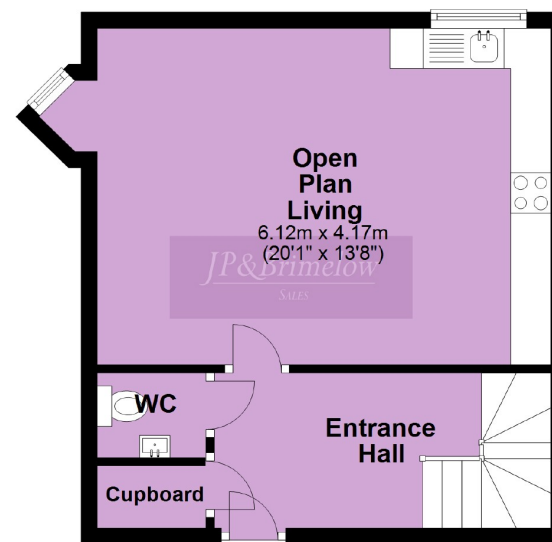

Chorlton & Didsbury Sales  
430 Barlow Moor Road, Chorlton, Manchester, M21 8AD  
Chorlton: 0161 882 2233 Didsbury: 0161 448 0622  
E: [chorlton@jpbrimelow.co.uk](mailto:chorlton@jpbrimelow.co.uk) [www.jpandbrimelow.co.uk](http://www.jpandbrimelow.co.uk)

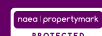

*JP&Brimelow*  
SALES

NOTICE: J P & Brimelow Chorlton & Didsbury Ltd for themselves and for the vendors or lessors of this property whose agents they are give notice that:

- (i) the particulars are set out as a general outline only for the guidance of intending purchasers or lessees, and do not constitute, nor constitute part of, an offer or contract;
- (ii) all descriptions, dimensions, references to the condition and necessary permissions for use and occupation, and other details are given in good faith and are believed to be correct but any intending purchasers or tenants should not rely on them as statements or representations of fact but must satisfy themselves by inspection or otherwise as to the correctness of each of them;
- (iii) no person in the employment of JP & Brimelow Ltd has any authority to make or give any representation or warranty whatever in relation to this property.



Follow us on Twitter @jpandbrimelows